



ANDREA

PATENTED

 5 YEARS WARRANTY

MATERIAL:

Vertical collector in painted carbon steel 90x30 mm.
Horizontal heating elements in painted carbon steel 50x20 mm.

FIXING KIT:

Brackets, airvent, hexagonal tool, plugs and screws for mounting suitable for use on compact or hollow brick, installation notice.
The fixing kit is compliant with VDI 6036 norm, class 4.

PACKAGING:

The radiator is protected by a film in polyethylene and with a carton box.
Use and maintenance notice included.

PAINTING PROCESS:

Painted with ecological epoxy. (Certificate DIN 55900-1,-2).
Thermal outputs certified in accredited laboratories in compliance with European norm EN442.

COLOURS:

Radiators and accessories: standard white R01 colour.
For other colours see colour chart.

PRODUCT CERTIFICATES



P. max: 5 bar

T. max: 110° C

Available for central heating systems

Connections: n° 2 x G 1/2" - n° 2 x G 1/2"

AWARD



REVERSIBLE



ACCESSORIES



Elegant square manual valve kit painted pure white R01

Copper connection Ø 12/14/15
Art. Nr. 5991990310553

Multilayer connection Ø 16 x2
Art. Nr. 5991990310552



Elegant square with thermostatic head valve kit, painted pure white R01

Copper connection Ø 12/14/15
Art. Nr. 5991990310539

Multilayer connection Ø 16 x2
Art. Nr. 5991990310538



Pipe covering kit for Pipe Centres 50 mm - valves polished

Art. Nr. 5103000000057



Tinta valve pipe centres 50 mm with thermostatic head - right - with pipe covering kit - pure white R01

Copper connection Ø 12/14/15
Art. Nr. 5991990311243

Multilayer connection Ø 16 x2
Art. Nr. 5991990311242



Tinta valve pipe centres 50 mm with thermostatic head left - with pipe covering kit - pure white R01

Copper connection Ø 12/14/15
Art. Nr. 5991990311245

Multilayer connection Ø 16 x2
Art. Nr. 5991990311244

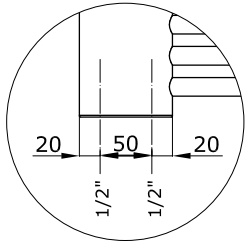
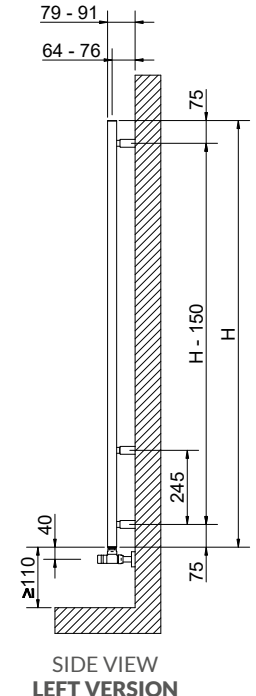
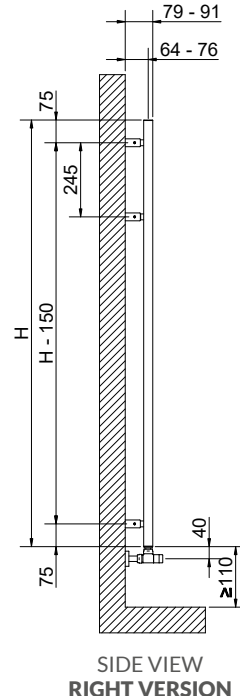
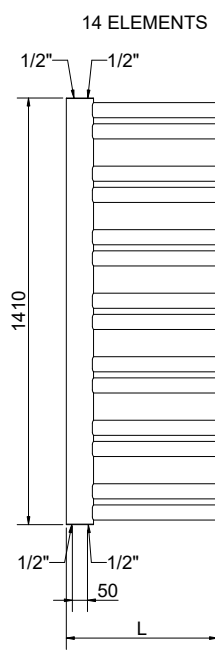
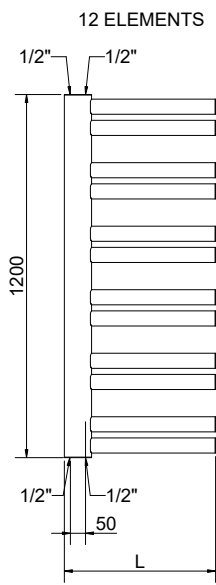
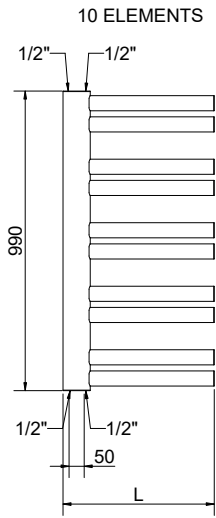
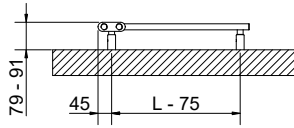
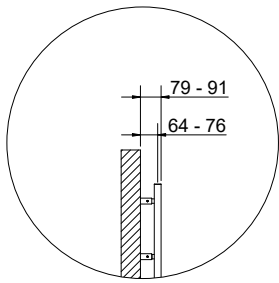

ANDREA

Art. Nr.	Height	Width	Pipe Centres	Dry Weight	Surface	Water Content	Thermal output Watt		Exponent n
	H [mm]	L [mm]	I [mm]	[Kg]	[m ²]	[lt]	$\Delta t = 50^{\circ}\text{C}$	$\Delta t = 30^{\circ}\text{C}$	
3551776100001	990	500	50	10,2	0,8	5,5	390	209	1,2326
3551776100002	1200	500	50	12,2	0,9	6,7	439	239	1,2457
3551776100003	1410	500	50	14,3	1,0	7,8	489	269	1,2499

Art. Nr. are referred to WHITE R01 colour version.

For output at different Δt than 50°C , please refer to the following formula = desired output = output at $\Delta t 50^{\circ}\text{C}$ x (desired $\Delta t/50$)ⁿ



INOX STYLE

EXTRASLIM®

NEO DESIGN

CLASSIC LINE

GRAPHIC PICTURE

ACCESSORIES
TECHNICAL SUPPORT